



# At last - it's here!

# Holdon PAT PEND

**Holdon™** - choose  
*Maxi for heavy duty or  
Mini for more beauty*

*Apply in seconds - no tools needed*

*Fantastic gripping power*

*Doesn't puncture or damage fabric*

*The harder the pull the tighter the grip*

*Locate Holdon eyelet in optimum  
number and position*

*Super performance on most fabrics,  
from polythene to PVC and light  
polyesters*

*Totally reusable and relocatable*



Distributed by:

## Instant eyelets - without tools!

WHO USE HOLDON ?

Holdon™ is such a convenient and versatile eyelet system that you will be finding new ways of using them and benefiting from their strength and efficiency. It's so simple; if you want to replace a broken traditional eyelet, make up a customised cover, mount a banner/sign or make up an attractive shade/awning, HOLDON™ MAKES IT EASY IN DOUBLE QUICK TIME.

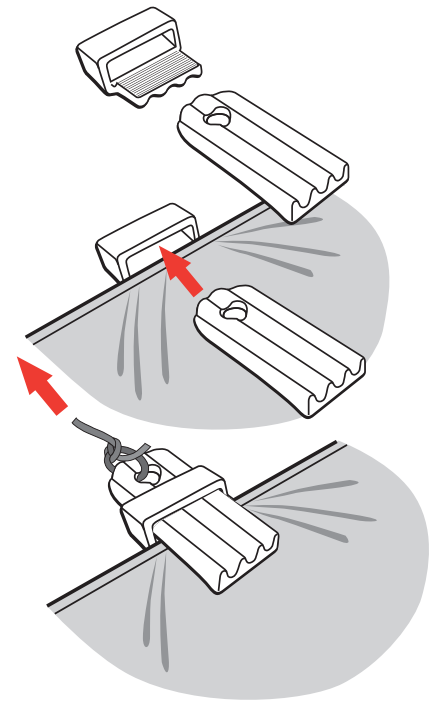

*Mount Holdon™ in line with the cord*

Banner makers supply them with their digitally printed banners to allow the user to fit Holdon™ at the optimum positioning. For the banner maker, this cuts out the laborious process of fitting traditional eyelets and often eliminates the need for hemming the banner. Camper, caravanners and sailors have so much confidence in their performance and gripping power that they keep a pack in their 'emergency kit' to effect urgent repairs and build storm-proof fabric covers.



*Holdon™ Mini on a banner*

Because they grip on virtually any material that fits into the Holdon™ jaws, farmers and gardeners find them great for securing all types of polythene and polycovers.

**HOW MANY USES CAN YOU FIND FOR THEM?**

# Technical specification

## Holdon™ Mini & Maxi



**Pat Pend**

Holdon™ Maxi

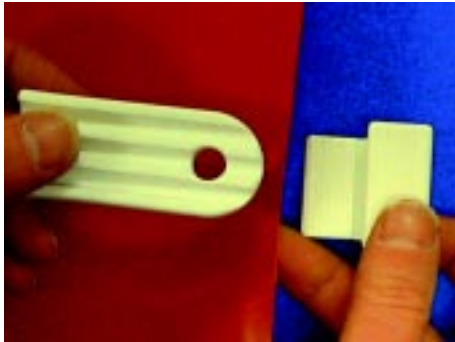

73x38x18 mm

35 gram

Holdon™ Mini



40x35x10 mm

12.5 gram

### Dimensions

### Weight

### Colours

White or green – special colours are available subject to minimum order quantities

### Material specification

Produced in Sweden - manufactured from glassfiber reinforced Nylon 6. Holdon™ in colour white contains UV-stabilizers. Holdon™ in other colours than white are protected from UV-deterioration by pigment additives, causing UV-blocking with the highest protection for black.

Temperature range for full strength: -30 degrees Celcius to + 100 degrees Celcius

Melting Temperature +220 degreec Celcius. Nylon 6 has considerably better high temperature resistance than PVC or polypropylene etc.

### Median loading capacity

100 kg

45 kg

Median loading capacity is determined by application of a series of separate static loadings to a Holdon™ eyelet installed on a 680/700 gms/sq.mtr. vinyl fabric. The median loading capacity represents an approximate safe working load that can be applied to the Holdon™, and in general terms determines the load bearing capacity of the bridge within the sleeve component.

### **IMPORTANT**

The median loading capacity does not in any way represent the efficiency or holding power of the Holdon™ – these elements of performance are also determined by both the correct application of the Holdon™ and by the physical characteristics of fabric/substrate/media onto which the Holdon™ is being applied.

### Application

In general terms, the 'flap' for the 'mini' illustrated in the photograph, is only required when applying it to very light weight/hard substrates such as polyester. The flap increases the frictional area and the efficiency of the 'grip'. The use of the 'flap' is at the discretion of the user.

### Packing weights and dimensions

Mini: white miniwell box of 250 Pcs weight 3.3 kg dimension 390 x 290 x 105 mm; printed instructions inside lid.

Maxi Brown well box 340x260x280 mm containing 2 inner boxes with 250 sleeves and 250 wedges. Weight 8.1 kg

The manufactures and/or its agents make no claims as to the holding power or suitability of the products on the application on which they are being used and that the use of the product is the sole responsibility of the user(s).